

Strainer

스 트 레 이 너

Y-Type 스트레이너

STR-1F/2F/3F 43



Strainer

STR-1F | 스트레이너(Y-Type Strainer)

- 파이프라인의 스케일 및 불순물 제거
- 관내 불순물에 의한 기기의 고장을 사전에 방지하여 기기를 보호함

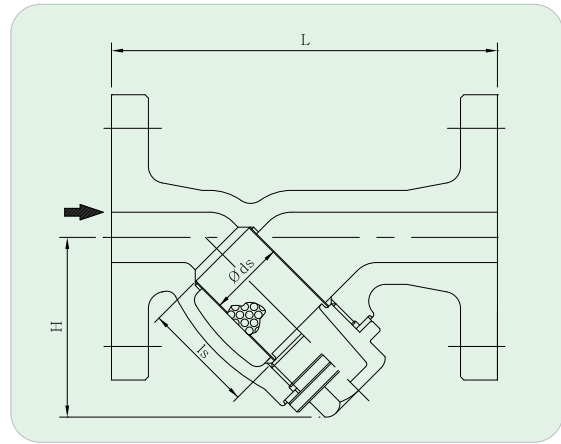

▶ 사양 (Specifications)

Working Pressure (kgf/cm ²)	10
Design Temperature (°C)	220
Connection	JIS 5K, 10K, 16K Flanged
Materials	Body : Cast Iron
	Trim : Stainless Steel

▶ 치수 (Dimensions)

Size	Part	15A	20A	25A	32A	40A	50A	65A	80A	100A
L		125	140	165	175	195	220	285	305	360
H		65	75	85	95	105	115	206	236	274
ls		34.3	49	63	66	75.5	87.5	160	190	230
ds		23	28	38	46	51	59	70	85	106

STR-2F/3F | 스트레이너(Y-Type Strainer)

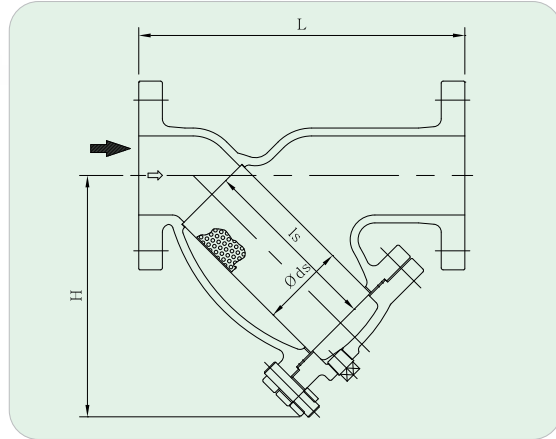

▶ 사양 (Specifications)

Model	STR-2F	STR-3F
Working Pressure (kgf/cm ² g)	20	30
Design Temperature (°C)	250	250
Connection	JIS 5K,10K,16K,20K Flanged	JIS 30K Flanged
Materials	Body : Cast Steel Stainless Steel	Body : Cast Steel Stainless Steel
	Trim : Stainless Steel	Trim : Stainless Steel

▶ 치수 (Dimensions)

STR-2F	15A	20A	25A	32A	40A	50A	65A	80A	100A	125A	150A	200A	250A	300A
L	125	140	165	175	195	220	289	313	364	414	484	578	714	833
H	65	75	85	95	105	115	206	236	275	325	380	450	524	587
ls	34.3	49	63	66	75.5	87.5	160	190	230	270	320	380	430	460
ds	23	28	38	46	51	59	70	85	106	134	160	206	270	330

STR-3F	15A	20A	25A	32A	40A	50A
L	135	140	170	182	202	220
H	65	75	85	95	105	115
ls	34.3	49	63	66	75.5	87.5
ds	23	28	38	46	51	59

※ STR-2F/3F - 주문에 따라 플랜지는 ANSI, DIN 규격으로도 제작할 수 있습니다.

※ STR-2F/3F - 주문에 따라 스테인레스 재질로 제작할 수 있습니다.

기술자료 | Strainer

▶ Screen

• 당사에서 사용하는 스크린의 종류는 다음과 같다

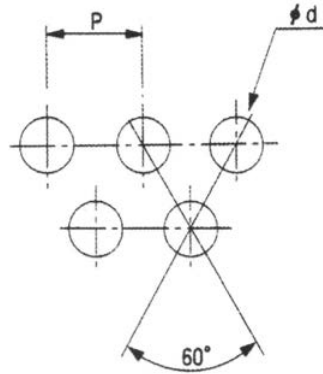

Type	타공판 망								돛자리 짜기식 망	
	단일망용				이중망용				선경	망눈수
Part	t	Ød	p	개구율(%)	t	Ød	p	개구율(%)		
15A~25A	0.25	0.8	1.5	25.88	0.5	3.0	4.0	51.19	가로 : 0.55 세로 : 0.8	가로 : 약 45눈 세로 : 약 10눈
32A~50A	0.3	1.0	1.7	31.48						
65A~100A	0.5	1.2	2.0	32.76	0.7	5.0	6.5	53.85		
125A~150A	0.6	1.5	2.2	42.30	1.0	8.0	10.0	58.24		
200A	0.8	1.8	2.5	47.17						

▶ 개구율 계산식

$$F = 91.0 \times d^2 / P^2$$

F : 개구율(%)
d : HOLE 지름(mm)
P : HOLE 피치(mm)

▶ 이중망용 MESH 규격

Mesh	Pitch	S. W. G	Wire DIA(mm)	Operture ratio(%)
20	1.2700	30	0.3150	56.5
40	0.6350	35	0.2134	44.1
60	0.4233	38	0.1524	41.2
80	0.3175	41	0.1118	42.0
100	0.2540	42	0.0813	37.5
120	0.2116	44	0.0813	37.5
160	0.1588	46	0.0613	37.0
200	0.1270	48	0.0406	36.2

Strainer

Y-Type Strainer

STR-1F/2F/3F 49



Strainer

STR-1F | Y-Type Strainer

► Specifications

Working Pressure (kgf/cm ² g)	10
Working Temperature (°C)	220
Connection	JIS 10K Flanged
Materials	Body : Cast Iron
	Trim : Stainless Steel



► Dimensions

Size	Part	15A	20A	25A	32A	40A	50A	65A	80A	100A
L		125	140	165	178	195	220	285	305	360
H		65	75	85	95	105	115	206	236	274
Is		34.3	49	63	66	75.5	87.5	160	190	230
ds		23	28	38	46	51	59	70	85	106

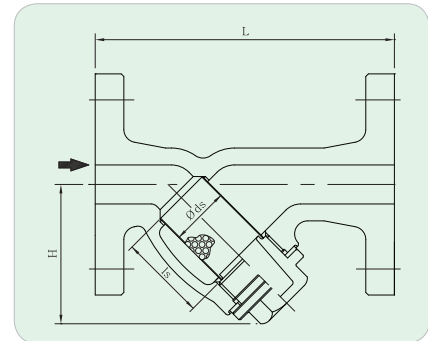

STR-2F/3F | Y-Type Strainer

► Specifications

Model	STR-2F	STR-3F
Working Pressure (kgf/cm ² g)	20	30
Working Temperature (°C)	250	250
Connection	JIS 20K Flanged	JIS 30K Flanged
Materials	Body : Cast Steel Stainless Steel	Body : Cast Steel Stainless Steel
	Trim : Stainless Steel	Trim : Stainless Steel



► Dimensions

STR-2F	15A	20A	25A	32A	40A	50A	65A	80A	100A	125A	150A	200A	250A	300A
L	125	140	165	175	195	220	289	313	364	414	484	578	714	833
H	65	75	85	95	105	115	206	236	275	325	380	450	524	587
Is	34.3	49	63	66	75.5	87.5	160	190	230	270	320	380	430	460
ds	23	28	38	46	51	59	70	85	106	134	160	206	270	330

STR-3F	15A	20A	25A	32A	40A	50A
L	135	140	170	182	202	220
H	65	75	85	95	105	115
Is	34.3	49	63	66	75.5	87.5
ds	23	28	38	46	51	59

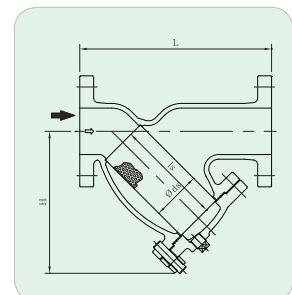

※ STR-2F/3F : ANSI and DIN Flange are available upon request

Engineering Data | Strainer

▶ Screen

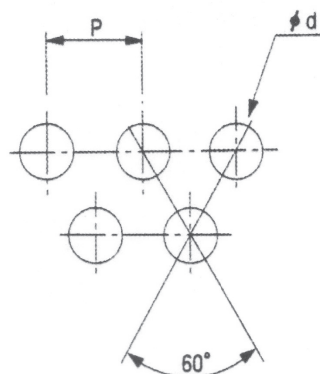

Type	Perforated Screen								Screen	
Part	Screen only				Double screen				Diameter	Quantity of screen
Size	t	Ød	p	Operture ratio(%)	t	Ød	p	Operture ratio(%)		
15A~25A	0.25	0.8	1.5	25.88	0.5	3.0	4.0	51.19	width : 0.55 height : 0.8	width : About 45 height : About 10
32A~50A	0.3	1.0	1.7	31.48						
65A~100A	0.5	1.2	2.0	32.76	0.7	5.0	6.5	53.85		
125A~150A	0.6	1.5	2.2	42.30	1.0	8.0	10.0	58.24		
200A	0.8	1.8	2.5	47.17						

▶ Operture ratio

$$F = 91.0 \times d^2 / P^2$$

F : Operture ratio(%)
 d : HOLE diameter(mm)
 P : HOLE pitch(mm)

▶ Mesh

Mesh	Pitch	S. W. G	Wire DIA(mm)	Operture ratio(%)
20	1.2700	30	0.3150	56.5
40	0.6350	35	0.2134	44.1
60	0.4233	38	0.1524	41.2
80	0.3175	41	0.1118	42.0
100	0.2540	42	0.0813	37.5
120	0.2116	44	0.0813	37.5
160	0.1588	46	0.0613	37.0
200	0.1270	48	0.0406	36.2